



Estate Agents

For more properties in your area  
Visit [www.meestateagents.me](http://www.meestateagents.me)



**£375,000** Freehold

Broadlands Close, Bentley, Farnham, GU10 5LE

|  |              |  |          |  |          |  |           |
|--|--------------|--|----------|--|----------|--|-----------|
|  | 846<br>Sq Ft |  | <b>2</b> |  | <b>1</b> |  | <b>79</b> |
|--|--------------|--|----------|--|----------|--|-----------|



**Broadlands Close, Bentley, Farnham, GU10**

Approximate Area = 846 sq ft / 78.6 sq m

For identification only - Not to scale

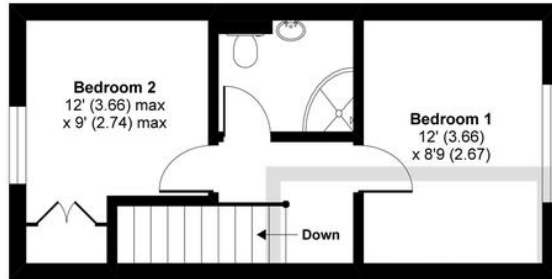

FIRST FLOOR

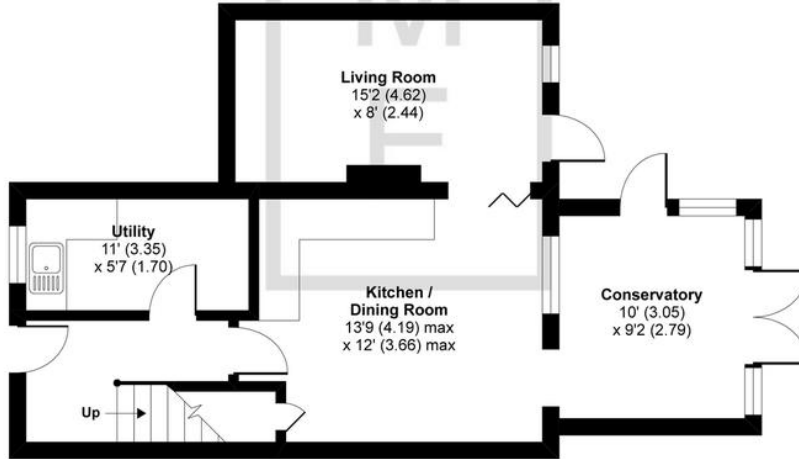

GROUND FLOOR



Floor plan produced in accordance with RICS Property Measurement Standards incorporating International Property Measurement Standards (IPMS2 Residential). © nichecom 2020. Produced for ME Estate Agents. REF: 621117

## Description

VIEW OUR VIRTUAL TOUR of this delightful village house with a lovely covered patio in a south west facing garden within a small close a short walk of the village church, pond, green and school with the shop and pub just a little further and the main line station.

- Living room
- Kitchen/dining room
- Utility
- Conservatory
- Parking

## More information

- EPC Rating

D